

Miniature Push-Pull Series – Atto Miniature Push-Pull

Technical Data

RoHS

Panel connector



Cable connector



Coupler connector



Panel connector, cable connector
and coupler connector

circular housing

Locking	Push-Pull, for frequent mating
Protection	IP 65 with flat-gasket for panel connector
Contacts	7 to 27 contacts \varnothing 0,76 mm, crimp or solder removable contacts
Max. current	5 A \varnothing 0,76 mm
Mechanical endurance	50000 locking and mating cycles
Contact resistance	< 3 m Ω
Breakdown voltage between adjacent contacts	> 1500 Volts (RMS)
Insulation resistance	> 5000 M Ω
Operating temperature	-40 °C to +100 °C (500 hours at +100 °C)
Materials	Nickel-plated light alloy, gold-plated brass contacts, neoprene insert
Max. conductor cross-section	0,34 mm ²

Dimensional Data

Square panel connector

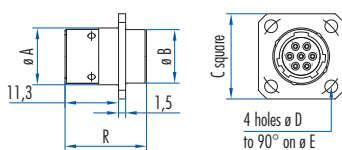

Circular panel connector

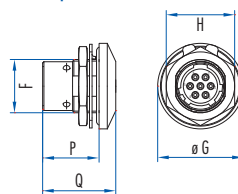

Cable connector

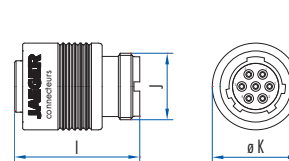

Coupler connector

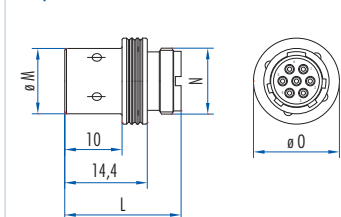

Housing	Number of Contacts	Square panel connector					Circular panel connector					Cable connector			Coupler connector			
		ø A	ø B	C	ø D	ø E	F	ø G	H	P	Q	I	J	ø K	L	ø M	N	ø O
00	7	12	11,3	18	2,7	18	M12,5	20	16	13,3	17,2	21,7	M11,5	15	20,3	11,4	M1,5	15
0	8-12-19	14,9	14,9	20	2,7	21	M16	23	19	13,3	17,2	22,2	M15	18,7	20,8	14,9	M15	18,7
1	27	21	20,9	27	3,2	28	M25	34	30	17,9	20,3	24,2	M20	25	24,2	20,1	M20	24

Part Number

Housing	00	0	0	0	1
Number of Contacts \varnothing 0,76 mm	7	8	12	19	27

Male panel connectors – Female cable connectors – Male coupler connectors

Square male panel connector	761 107 006	761 108 006	761 112 006	761 119 006	761 127 006
Circular male panel connector	761 107 206	761 108 206	761 112 206	761 119 206	761 127 206
Female cable connector	762 207 006	762 208 006	762 212 006	762 219 006	762 227 006
Male coupler connector	763 107 006	763 108 006	763 112 006	763 119 006	763 127 006
Long cable gland	769 807 006	769 819 006	769 819 006	769 819 006	769 827 006
Flat-Gasket for panel connector (pack of 10)	533 328 006	533 368 006	533 368 006	533 368 006	536 945 006
Cable clamps	769 607 006	769 619 006	769 619 006	769 619 006	769 627 006
Protective cap for panel connector	533 610 006	533 650 006	533 650 006	533 650 006	761 907 006
Protective cap for cable connector	536 620 006	536 660 006	536 660 006	536 660 006	536 610 006

Crimp tool without positioner 630 180 006, positioner 769 100 006

Tool for insertion and removing contacts 769 131 006

Female panel connectors – Male cable connectors – Female coupler connectors

Square female panel connector	761 207 006	761 208 006	761 212 006	761 219 006	761 227 006
Circular female panel connector	761 207 206	761 208 206	761 212 206	761 219 206	761 227 206
Male cable connector	762 107 006	762 108 006	762 112 006	762 119 006	762 127 006
Female coupler connector	763 207 006	763 208 006	763 212 006	763 219 006	763 227 006
Long cable gland	769 807 006	769 819 006	769 819 006	769 819 006	769 827 006
Flat-Gasket for panel connector (pack of 10)	533 328 006	533 368 006	533 368 006	533 368 006	536 945 006
Cable clamps	769 607 006	769 619 006	769 619 006	769 619 006	769 627 006
Protective cap for panel connector	533 610 006	533 650 006	533 650 006	533 650 006	761 907 006
Protective cap for cable connector	536 620 006	536 660 006	536 660 006	536 660 006	536 610 006

Crimp tool without positioner 630 180 006, positioner 769 100 006

Tool for insertion and removing contacts 769 131 006

- Straight and right-angle panel connectors are also available for printed circuit boards.
- **Important:** All the contacts must be mounted in the insert using our tool.
- For assembly, wiring, panel connector installation and contact arrangement instructions, see: Technical guides;
- Other accessories, see: Accessories.
- All connectors are delivered with their contacts.

Technical Data

RoHS

Panel connector



Cable connector



Coupler connector



Panel connector, cable connector
and coupler connector

circular housing

Locking	Push-Pull, for frequent mating
Protection	IP 65 with flat-gasket for panel connector except for housing 1 IP 50 to 54 with conexil in the housing and flat-gasket for panel connector
Contacts	3 to 19 contacts \varnothing 1 mm, \varnothing 1,6 mm and \varnothing 2,4 mm, crimp or solder removable contacts
Max. current	7 A \varnothing 1 mm, 15 A \varnothing 1,6 mm et 30 A \varnothing 2,4 mm
Mechanical endurance	50000 locking and mating cycles
Contact resistance	< 2 m Ω 1 mm – < 1,5 m Ω 1,6 mm – < 1 m Ω 2,4 mm
Breakdown voltage between adjacent contacts	> 2500 Volts (RMS)
Insulation resistance	> 5000 M Ω
Operating temperature	-40 °C to +100 °C (500 hours at +100 °C)
Materials	Nickel-plated light alloy, gold-plated brass contacts, neoprene insert
Max. conductor cross-section	0,93 mm ² for 3–7 or 12 contacts \varnothing 1 mm 0,60 mm ² for 4 or 19 contacts \varnothing 1 mm 1,50 mm ² for 3–4 or 7 contacts \varnothing 1,6 mm 3,18 mm ² for 3 or 4 contacts \varnothing 2,4 mm

Dimensional Data

Square panel connector

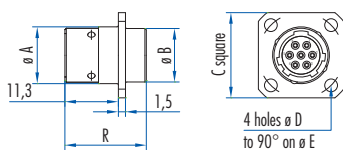

Circular panel connector

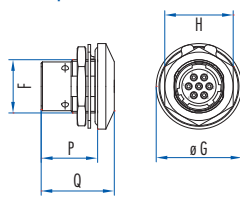

Cable connector

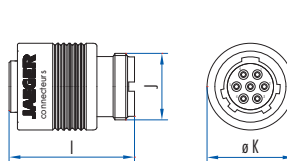

Coupler connector

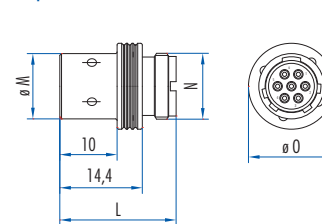

Housing	\varnothing mm	Number of Contacts	Square panel connector					Circular panel connector					Cable connector			Coupler connector			
			\varnothing A	\varnothing B	C	\varnothing D	\varnothing E	F	\varnothing G	H	P	Q	I	J	\varnothing K	L	\varnothing M	N	\varnothing O
00	1	3-4	12	11,3	18	2,7	18	M12,5	20	16	13,3	17,2	21,7	M11,5	15	20,3	11,4	M11,5	15
0	1	7	14,9	14,9	20	2,7	21	M16	23	19	13,3	17,2	22,2	M15	18,7	20,8	14,9	M15	18,7
1	1	12-19	21	20,9	27	3,2	28	M25	34	30	17,9	20,3	24,2	M20	25	24,2	20,1	M20	24
1	1,6	3-4-7	21	20,9	27	3,2	28	M25	34	30	17,9	20,3	24,2	M20	25	24,2	20,1	M20	24
1	2,4	3-4	21	20,9	27	3,2	28	M25	34	30	17,9	20,3	24,2	M20	25	24,2	20,1	M20	24

Miniature Push-Pull Series – Natto Miniature Push-Pull

Part Number

Housing	00	00	0	1	1	1	1	1	1	1
Number of Contacts	3	4	7	12	19	3	4	7	3	4
L ø mm	1	1	1	1	1	1,6	1,6	1,6	2,4	2,4

Male panel connectors – Female cable connectors – Male coupler connectors

Square male panel connector	533 233 006	533 801 006	533 273 006	533 283 006	533 293 006	535 310 006	535 350 006	535 390 006	535 430 006	535 470 006
Circular male panel connector	533 239 006	533 811 006	533 279 006	533 319 006	533 359 006	535 310 206	535 350 206	535 390 206	535 430 206	535 470 206
Female cable connector	530 232 006	530 801 006	530 272 006	530 282 006	530 292 006	535 111 006	535 151 006	535 191 006	535 231 006	535 271 006
Male coupler connector	530 239 006	530 811 006	530 279 006	530 812 006	530 815 006	535 210 006	535 250 006	535 290 006	535 330 006	535 370 006
Union nut	530 330 006	530 840 006	530 370 006							
Flat-Gasket for panel connector (pack of 10)	533 328 006	533 328 006	533 368 006	536 945 006	536 945 006	536 945 006	536 945 006	536 945 006	536 945 006	536 945 006
Cable clamps	530 331 006	530 841 006	530 371 006	769 627 006	769 627 006	769 627 006	769 627 006	769 627 006	769 627 006	769 627 006
Protective cap for panel connector	533 610 006	533 610 006	533 650 006	761 907 006	761 907 006	761 907 006	761 907 006	761 907 006	761 907 006	761 907 006

Complete crimp tool: 579 316 006 (small crimp: ø 1 mm), 579 481 006 (large crimp: ø 1 mm, ø 1,6 mm, ø 2,4 mm)

Tool for insertion and removing contacts ø 1 mm 597 104 006, ø 1,6 mm 577 454 006 ø 2,4 mm 577 458 006

Female panel connectors – Male cable connectors – Female coupler connectors

Square female panel connector	533 232 006	533 800 006	533 272 006	533 282 006	533 292 006	535 311 006	535 351 006	535 391 006	535 431 006	535 471 006
Circular female panel connector	533 238 006	533 810 006	533 278 006	533 318 006	533 358 006	535 311 206	535 351 206	535 391 206	535 431 206	535 471 206
Male cable connector	530 233 006	530 800 006	530 273 006	530 283 006	530 293 006	535 110 006	535 150 006	535 190 006	535 230 006	535 270 006
Female coupler connector	530 238 006	530 810 006	530 278 006	530 813 006	530 816 006	535 211 006	535 251 006	535 291 006	535 331 006	535 371 006
Union nut	530 330 006	530 840 006	530 370 006							
Flat-Gasket for panel connector (pack of 10)	533 328 006	533 328 006	533 368 006	536 945 006	536 945 006	536 945 006	536 945 006	536 945 006	536 945 006	536 945 006
Cable clamps	530 331 006	530 841 006	530 371 006	769 627 006	769 627 006	769 627 006	769 627 006	769 627 006	769 627 006	769 627 006
Protective cap for cable connector	536 620 006	536 620 006	536 660 006	536 610 006	536 610 006	536 610 006	536 610 006	536 610 006	536 610 006	536 610 006

Complete crimp tool: 579 316 006 (small crimp: ø 1 mm), 579 481 006 (large crimp: ø 1 mm, ø 1,6 mm, ø 2,4 mm)

Tool for insertion and removing contacts ø 1 mm 597 104 006, ø 1,6 mm 577 454 006 ø 2,4 mm 577 458 006

- Straight and right-angle panel connectors are also available for printed circuit boards.
- **Important:** All the contacts must be mounted in the insert using our tool.
- For assembly, wiring, panel connector installation and contact arrangement instructions, see: Technical guides;
- Other accessories, see: Accessories.
- Polarisation: Polarisation systems are available to prevent incorrect connection between identical connectors (same series and same contact arrangement). Consult us.
- All connectors are delivered with their contacts.
- Thermocouple contacts can be fitted. See: Accessories.
- ø 1,6 mm and ø 2,4mm, contact No. 1, which makes the electrical connection before the other contacts and disconnects it after their separation, can be used as a ground contact.

Technical Data

Panel connector



Cable connector



Coupler connector



Panel connector, cable connector
and coupler connector

circular housing

Locking	Push-Pull, for frequent mating
Protection	IP 65 with flat-gasket for panel connector except for housing 1 IP 50 to 54 with conexil in the housing and flat-gasket for panel connector
Contacts	3 to 19 contacts \varnothing 1 mm, \varnothing 1,6 mm and \varnothing 2,4 mm, crimp or solder removable contacts
Max. current	7 A \varnothing 1 mm, 15 A \varnothing 1,6 mm et 30 A \varnothing 2,4 mm
Mechanical endurance	50000 locking and mating cycles
Contact resistance	< 2 m Ω 1 mm – < 1,5 m Ω 1,6 mm – < 1 m Ω 2,4 mm
Breakdown voltage between adjacent contacts	> 2500 Volts eff
Insulation resistance	> 5000 M Ω
Operating temperature	-55 °C to +200 °C (500 hours at +200 °C)
Materials	Light alloy, black anodising, gold-plated brass contacts, silicon insert
Max. conductor cross-section	0,93 mm ² for 3–7 or 12 contacts \varnothing 1 mm 0,60 mm ² for 4 or 19 contacts \varnothing 1 mm 1,50 mm ² for 3–4 or 7 contacts \varnothing 1,6 mm 3,18 mm ² for 3 or 4 contacts \varnothing 2,4 mm

Dimensional Data

Square panel connector

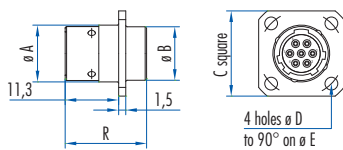

Circular panel connector

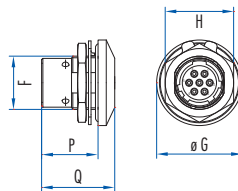

Cable connector

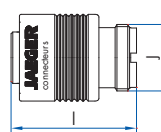

Coupler connector

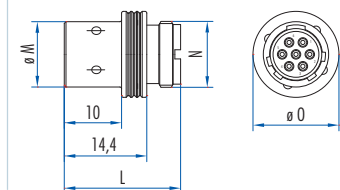

Housing	\varnothing mm	Number of Contacts	Square panel connector					Circular panel connector					Cable connector			Coupler connector			
			\varnothing A	\varnothing B	C	\varnothing D	\varnothing E	F	\varnothing G	H	P	Q	I	J	\varnothing K	L	\varnothing M	N	\varnothing O
00	1	3-4	12	11,3	18	2,7	18	M12,5	20	16	13,3	17,2	21,7	M11,5	15	20,3	11,4	M11,5	15
0	1	7	14,9	14,9	20	2,7	21	M16	23	19	13,3	17,2	22,2	M15	18,7	20,8	14,9	M15	18,7
1	1	12-19	21	20,9	27	3,2	28	M25	34	30	17,9	20,3	24,2	M20	25	24,2	20,1	M20	24
1	1,6	3-4-7	21	20,9	27	3,2	28	M25	34	30	17,9	20,3	24,2	M20	25	24,2	20,1	M20	24
1	2,4	3-4	21	20,9	27	3,2	28	M25	34	30	17,9	20,3	24,2	M20	25	24,2	20,1	M20	24

Miniature Push-Pull Series – Natto Miniature Push-Pull High-Performance

Part Number

Housing	00	00	0	1	1	1	1	1	1	1
Number of Contacts	3	4	7	12	19	3	4	7	3	4
L ø mm	1	1	1	1	1	1,6	1,6	1,6	2,4	2,4

Male panel connectors – Female cable connectors – Male coupler connectors

Square male panel connector	533 603 006	533 804 006	533 604 006			535 610 006	535 650 006	535 690 006		
Circular male panel connector	533 603 206	533 804 206	533 604 206			535 610 206	535 650 206	535 690 206		
Female cable connector	530 603 006	530 804 006	530 604 006			535 411 006	535 451 006	535 491 006		
Male coupler connector	530 633 006	530 824 006	530 634 006			535 510 006	535 550 006	535 590 006		
Flat-Gasket for panel connector (pack of 10)	533 328 016	533 328 016	533 368 016	536 945 016	536 945 016	536 945 016	536 945 016	536 945 016	536 945 016	536 945 016
Cable clamps	530 692 006	530 844 006	530 693 006							
Protective cap for panel connector	533 610 106	533 610 106	533 650 106			761 907 106	761 907 106	761 907 106		

Complete crimp tool: 579 316 006 (small crimp: ø 1 mm), 579 481 006 (large crimp: ø 1 mm, ø 1,6 mm, ø 2,4 mm)

Tool for insertion and removing contacts ø 1 mm 597 104 006, ø 1,6 mm 577 454 006 ø 2,4 mm 577 458 006

Female panel connectors – Male cable connectors – Female coupler connectors

Square female panel connector	533 613 006	533 814 006	533 614 006			535 611 006	535 651 006	535 691 006		
Circular female panel connector	533 613 206	533 814 206	533 614 206			535 611 206	535 651 206	535 691 206		
Male cable connector	530 613 006	530 814 006	530 614 006			535 410 006	535 450 006	535 490 006		
Female coupler connector	530 623 006	530 834 006	530 624 006			535 511 006	535 551 006	535 591 006		
Flat-Gasket for panel connector (pack of 10)	533 328 016	533 328 016	533 368 016	536 945 016	536 945 016	536 945 016	536 945 016	536 945 016	536 945 016	536 945 016
Cable clamps	530 692 006	530 844 006	530 693 006							
Protective cap for cable connector	536 620 106	536 620 106	536 660 106			536 610 106	536 610 106	536 610 106		

Complete crimp tool: 579 316 006 (small crimp: ø 1 mm), 579 481 006 (large crimp: ø 1 mm, ø 1,6 mm, ø 2,4 mm)

Tool for insertion and removing contacts ø 1 mm 597 104 006, ø 1,6 mm 577 454 006 ø 2,4 mm 577 458 006

- **Important:** All the contacts must be mounted in the insert using our tool.
- For assembly, wiring, panel connector installation and contact arrangement instructions, see: Technical guides;
- Other accessories, see: Accessories.
- Polarisation: Polarisation systems are available to prevent incorrect connection between identical connectors (same series and same contact arrangement). Consult us.
- All connectors are delivered with their contacts.
- Thermocouple contacts can be fitted. See: Accessories.
- ø 1,6 mm and ø 2,4mm, contact No.1, which makes the electrical connection before the other contacts and disconnects it after their separation, can be used as a ground contact.